

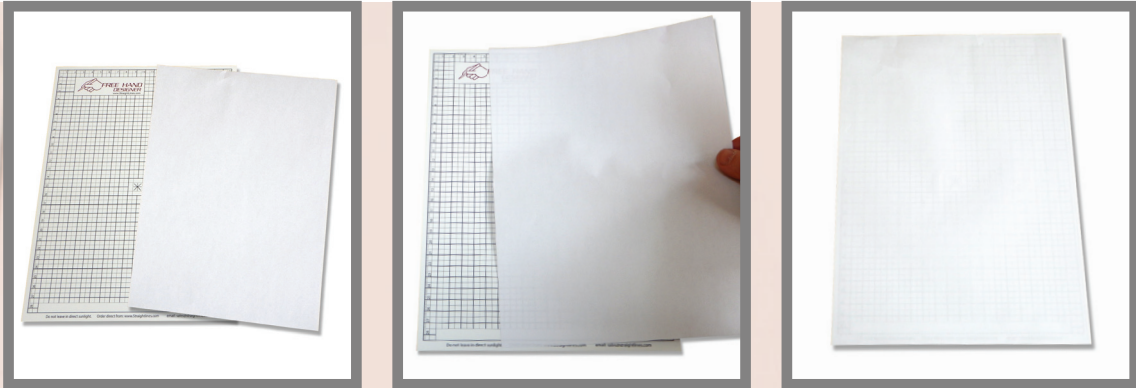

DRAW PERFECT STRAIGHT LINES TOTALLY FREEHAND!

How to use the 'FREEHAND DESIGNER'



Place the 'FREEHAND DESIGNER' under a regular sheet of paper.

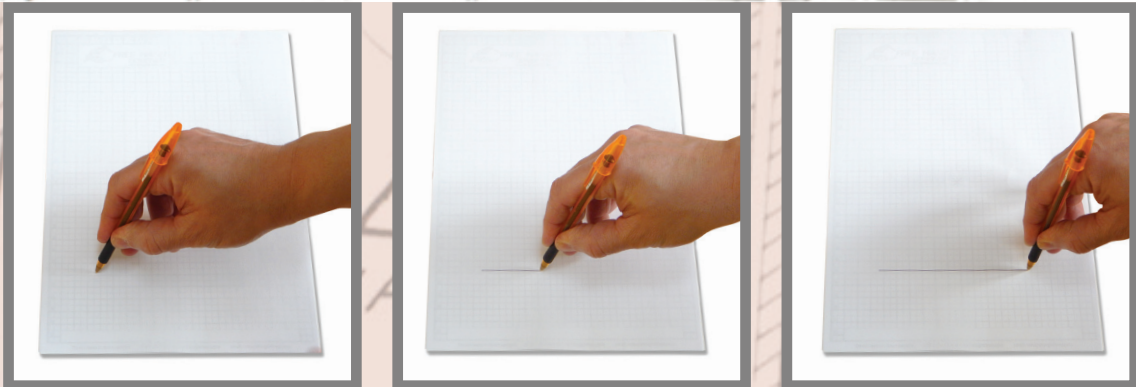

Keep your pen or pencil upright to the page, apply a little pressure and draw a perfect straight line. You can see the grid through the paper, which also enables you to do your drawings to scale if required.

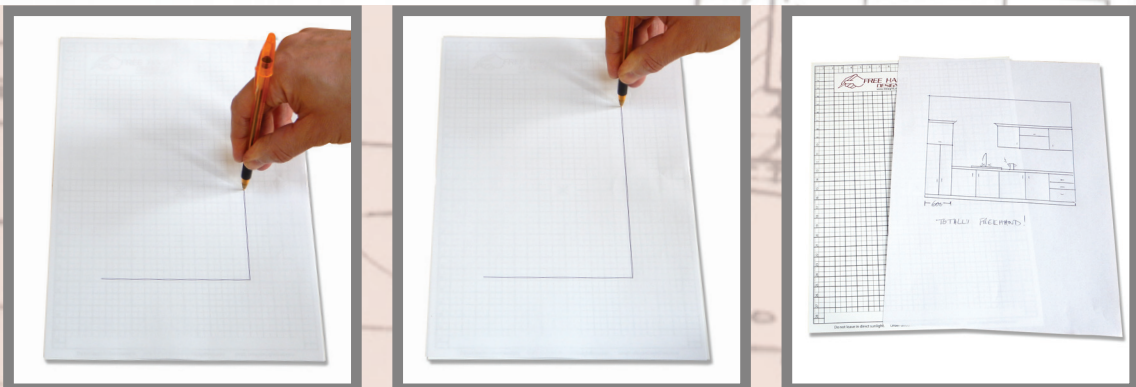

If you want to take notes or draw non straight lines, apply less pressure, so the point of your pen or pencil overrides the grooves in the 'FREEHAND DESIGNER'.

Great for a quick neat professional sketch or survey first time, everytime.

Freehand Designers available in metric A4 & A3 versions and US Letter size 8½" x 11" & Ledger 11" x 17" versions.